



# Welcome to Warner!

Melissa Sturge-Apple, Interim Dean

Cynthia Callard, Associate Dean for Graduate Studies

Pam Black-Colton, Executive Director, Office for Student Success



**WARNER**  
SCHOOL OF EDUCATION  
UNIVERSITY of ROCHESTER

# Today's Agenda

- **Welcome**

- *Melissa Sturge-Apple, Interim Dean*

- **Introduction to the Office for Student Success**

- *Pam Black-Colton, Director of Office for Student Success*

- **Title IX**

- *Professor Carol St. George*

- **Academic Overview**

- *Cindy Callard, Associate Dean of Graduate Studies*

- **Introduction to Library Services**

- *Eileen Daly-Boas, Librarian for Warner*

- **Next Steps & Upcoming Events**

- *Pam Black-Colton, Director of Office for Student Success*

- **Certification**

- *Pam Kaptein, Certification Officer*

# Office for Student Success Partners

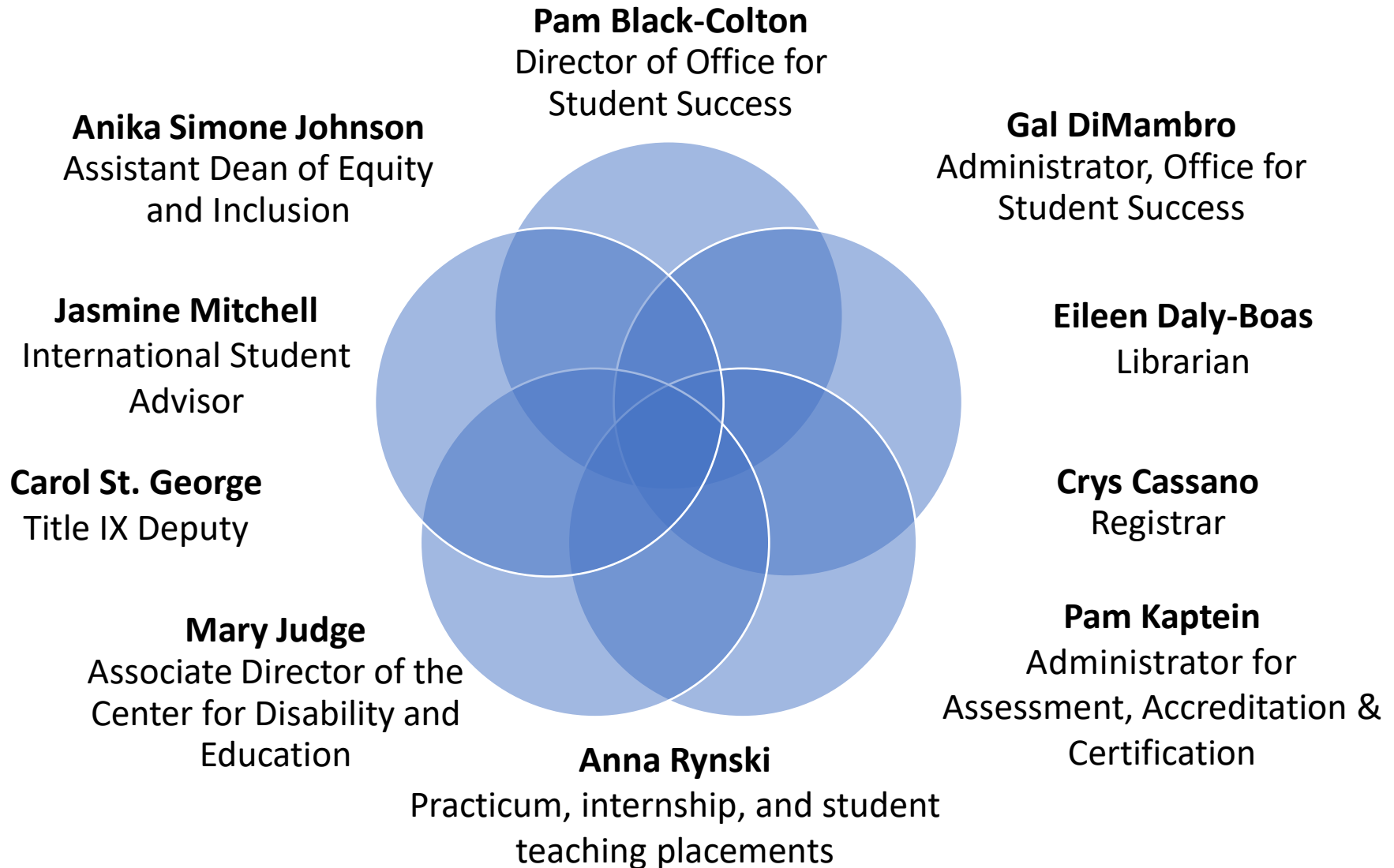

# Student Support



## Office for Student Success

- Pamela Black-Colton, Executive Director  
[pblackcolton@warner.rochester.edu](mailto:pblackcolton@warner.rochester.edu)
- [studentsuccess@warner.rochester.edu](mailto:studentsuccess@warner.rochester.edu)



## CARE Network

- UR Care Network referral:
  - <https://www.rochester.edu/care/>



## Title IX

- Carol St. George, Warner Deputy Title IX Coordinator:  
[cstgeorge@warner.rochester.edu](mailto:cstgeorge@warner.rochester.edu)
- <http://www.rochester.edu/sexualmisconduct>



## Disability Accommodations

- Mary Judge Diegert, Warner Disability Resource Coordinator:  
[mjudge@warner.rochester.edu](mailto:mjudge@warner.rochester.edu); (585) 273-1838; LeChase Hall 470



# Getting Started at Warner

- **University ID**

- Swipe access to LeChase Hall after business hours & on weekends/holidays
- ID Office Location: Susan B. Anthony Hall, Room 114A.
- Hours: Monday - Friday, 8:00am - 4:30pm

- **Parking**

- Walk-up student parking registration available
- Location: 8 Goler House
- Hours: Monday – Friday, 8:00am – 4:30pm

- **Email**

- Set up your Warner email & check it regularly!

# LeChase Hall and UR Campus

## Building Hours

- 
- Weekdays
    - 7:00 am - 5:00 pm: building is open and unlocked
    - 5:00 pm - 7:00 am: swipe access to building is required
  - Weekends & Holidays
    - Swipe access to building is required

## Classrooms

- 
- 14 classrooms located on the first floor of the building.
  - The Genrich-Rusling Room (215), Palladoro Methods Classroom (481), the Miller Technology and Research Lab (285) are also used as classrooms.
  - Classrooms are locked at all times. Rooms will automatically unlock 15-minutes prior to the start of every class and will remain unlocked for 15-minutes after class end time.

# LeChase Hall - First Floor

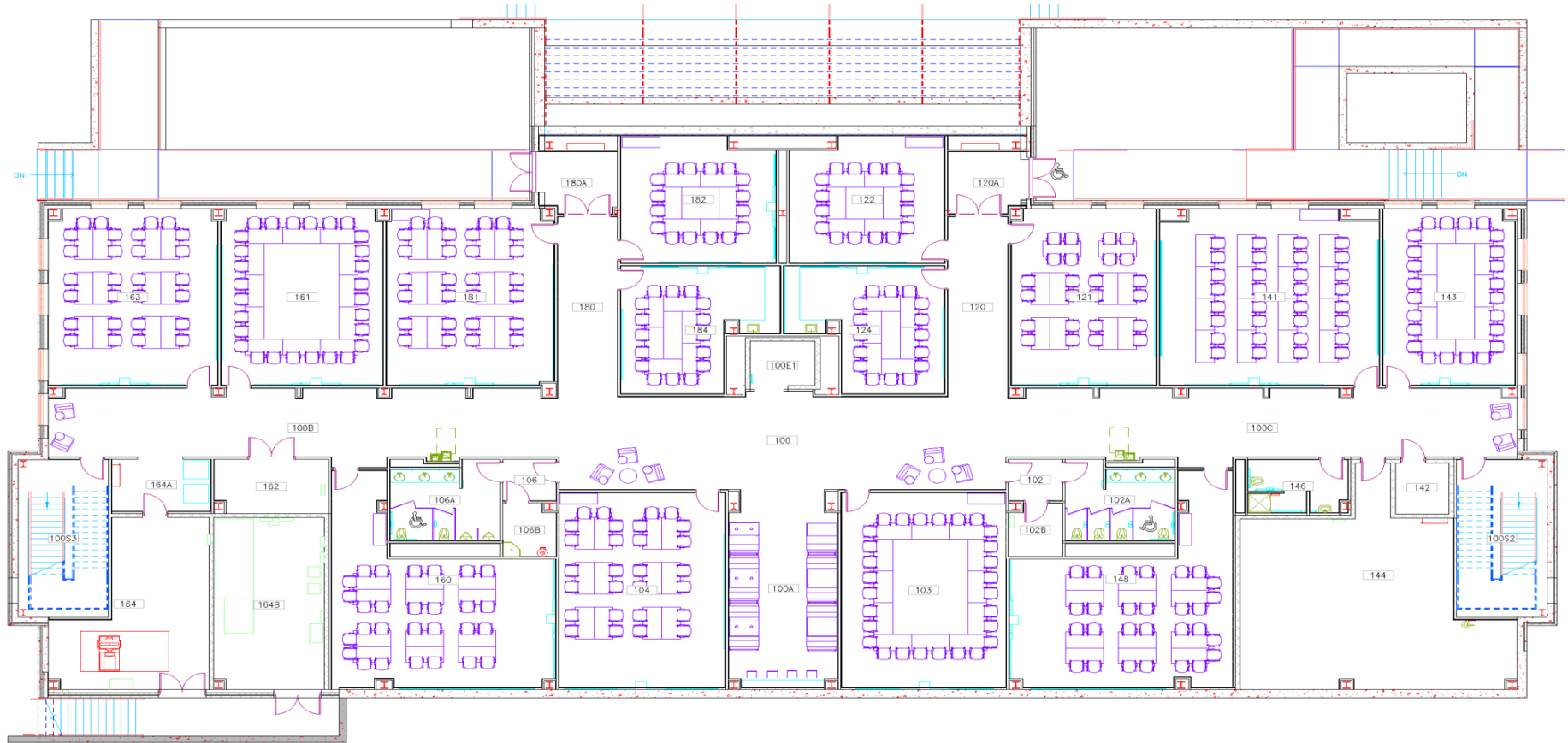

# Title IX

- Enforced by the U.S. Department of Education's Office for Civil Rights.
- Protects people from discrimination based on sex, including sexual orientation and gender identity in education programs or activities that receive federal financial assistance.
- Under Title IX, sexual discrimination includes harassment on the basis of sex.

This can happen many ways including:

Verbal or written harassment

Sexual assault, including rape and other unwanted sexual touching

Stalking (when on the basis of sex)

Dating or domestic violence

<https://www.rochester.edu/sexualmisconduct/>





# Title IX

- To contact the Title IX Office, please send an email to [titleix@rochester.edu](mailto:titleix@rochester.edu). The inbox is checked from 9am - 5pm, Monday - Friday (not checked on weekends or holidays).
- The Title IX Office is part of the University of Rochester's [Office of Equity and Inclusion](#).
- **Get Immediate Help**
  - Call [University Public Safety](#): (585) 275-3333
  - Dial #13 on campus blue phones
  - Call 911 (Police Dispatch, Monroe County Emergency Communications)



## What do you need to do?

- In the FALL all university faculty, students and staff will receive information about how to complete a training. More information will be provided prior to this.

## Who do I contact at Warner about Title IX?

- **TitleIX Office**

[TitleIX@Rochester.edu](mailto:TitleIX@Rochester.edu)

- Carol St George, Deputy Title IX Coordinator –  
[cstgeorge@warner.rochester.edu](mailto:cstgeorge@warner.rochester.edu)



# My Warner

Summer 2024 Course Schedule x Warner School of Education | U x Programs of Study x POS: M.S. in Reading and Litera x +

https://www.warner.rochester.edu

ly Drive - Google... Warner School of E... Course Schedules |... Box | Login UR Student (Workd... Student Aid Manag... NSF Proposals, Awa... Office of College &... Register or Change...

Students Alumni International Applicants My Warner Give Contact

 **WARNER**  
SCHOOL OF EDUCATION  
UNIVERSITY OF ROCHESTER

Degrees Admissions Faculty & Research Blog About



<https://www.warner.rochester.edu/>

See “Students” Tab

# Getting Started on Your Academic Journey at Warner

- **Log into “My Warner”**
  - <https://www.warner.rochester.edu/>
- **Connect with your Faculty Advisor**
  - Assigned at admissions
  - Found in My Warner
- **Work with your advisor on your Program of Study (POS)**
  - Found in My Warner
- **Register in UR Student**
  - [Public Course Schedule](#)
  - [UR Student](#)
- **Review [Warner Policies](#)**

# Technology Support



## IT Support Office

- [support@warner.rochester.edu](mailto:support@warner.rochester.edu)
- 585-270-1870
- LeChase Hall 364
- Monday - Thursday, 8:30 am - 8:00 pm
- Friday, 8:30 am - 4:30 pm



## Blackboard Support

- Contact: Audrey Lai or Bishes Shretha  
[Blackboard@warner.rochester.edu](mailto:Blackboard@warner.rochester.edu)

# Program of Study: Your Program Roadmap

Student : \_\_\_\_\_

Student ID: \_\_\_\_\_

[Sign out \(29:54\)](#)

*University of Rochester, Warner School Program Plan of Study*

## **M.S. in Reading and Literacies (birth-grade 6)[SR1]**

*(as of 02/01/2015)*

### **Leading to the following NYS Certifications:**

- Teaching Literacy (birth to grade 6) (Initial + professional)
- Professional teaching certification in the original area of certification

See <https://www.warner.rochester.edu/students/support/certification> for important certification information.

**NYS Code: 25038      HEGIS#: 0830.00      Dept: TC      Program: SR1**

Program	Credits	(Y/N)	Status	Advisor	Expected or Actual		
					Start Term	Intern. Start	Grad. Date
<b>SR1-MS-Literacy B-6</b>	<b>36</b>						
<i>Additional Option(s)</i>							
<a href="#">UT1-CAS Urban Teaching</a>	6						
<a href="#">OT3-Cert-K12 DTL</a>	6+						
<a href="#">NT1-Cert-TESOL/T</a>	7+						

**NOTE: Program requirements and related program of study forms may change over time as a result of our commitment to ongoing curriculum improvement. Students are expected to follow the most recent guidelines in preparing their program of study for approval. Please make sure this form reflects the most recent updates.**

**The following plan for completing the course and other requirements has been approved by:**

Student: _____	Signature: _____	Date: _____	<input type="checkbox"/>
Advisor: _____	Signature: _____	Date: _____	<input type="checkbox"/>
Program Chair: _____	Signature: _____	Date: _____	<input type="checkbox"/>
Associate Dean: _____	Signature: _____	Date: _____	<input type="checkbox"/>



# Program of Study: Your Program Roadmap

<b>Masters' Core</b>			
<a href="#">ED406</a>	Master's Research Methods ( <i>Online options</i> )	3	F, Sp, SuA, SuA&B, SuB
<a href="#">EDU442</a>	Race, Class, Gender, and Disability in American Education ( <i>Online options</i> )	3	F, Sp, SuB
OR:			
<a href="#">ED404</a>	Teaching, Curriculum, and Change	3	F
<b>Subtotal: _____</b>			
<b>Specialization Courses</b>			
<a href="#">ED446</a>	Collaborative Teaching Partnerships in Inclusive Classrooms ( <i>Hybrid options</i> )	3	Sp, SuB
<a href="#">ED405</a>	Assessment in Instructional Contexts ( <i>Online options</i> )	3	F, SuA
<a href="#">EDU498</a>	Literacy Learning as Social Practice ( <i>Online options</i> )	3	F, Sp, SuA
<a href="#">ED409</a>	Language and Literacy in Education [ <a href="#">EDU498</a> recommended]	3	F, Sp
<a href="#">EDU427A</a>	Theory and Practice in Teaching & Learning Literacy (for non-Elementary Teaching Candidates)	3	F
<a href="#">EDU495</a>	Theory and Practice for Reading Professionals [ <i>Course must be taken concurrently with <a href="#">EDF422</a>; <a href="#">EDU498</a> recommended</i> ]	3	Sp
<b><i>Choose 2 reading electives; options include but are not limited to:</i></b>			
<a href="#">EDU440</a>	Children's Literature and Literacy Learning ( <i>Online options</i> )	3	SuB
<a href="#">EDE444</a>	Children's Literature Across the World	3	Occ
<a href="#">EDU467</a>	Language, Literacy, and Cognitive Development	3	Sp(even)
<a href="#">ED480</a>	Second Language Acquisition and Bilingualism ( <i>Online options</i> )	3	F, Sp

# Program of Study

## Additional Requirements

### SR1 Additional requirements:

	Expected completion date	Actual completion date
<b>Required for Program Completion</b>		
Master's Essay or Thesis		
Dignity for All Students (DASA) Training in Harassment, Bullying, Cyberbullying, & Discrimination Prevention and Intervention		
<b>Required for Recommendation</b>		
Initiate NY State Teacher certification process with the Warner School Certification Officer		
<b>Required for Certification (key items)</b>		
Initial Teaching Certification in elementary education		
NYS Exam - edTPA (Passed in first subject area) <i>(Required for program completion with Spring 2019 admits)</i>		
NYS Exam - Content Specialty Test (CST) for each area of specialization sought <i>(Required for program completion with Spring 2019 admits)</i>		
3 Years of Teaching Experience with the First One Conducted in a Mentored Situation <i>(NOT a graduation requirement but needed before applying for professional certification)</i>		
Additional admissions conditions that need to be fulfilled prior to graduation (if any are listed below):		
+		

# Capstone Project

- New York State registered programs
- Capstone project included
- Cannot be a program completer, i.e. graduate, until capstone is completed
- **Approximate** deadlines for each grad cycle

Graduation Cycle	Deadline for advisor to confirm completion
August	Last Friday of July
October	Tuesday after Labor Day
December	Third Friday in November
February	Last Friday in January
May	Second Friday of April



# Additional Notes about Coursework

- Allocate Sufficient Time
  - 2 hours of outside work for every hour class time
- Maintain Good Status
  - One “C” Grade - Academic Probation
  - Two “C” Grades - Involuntary Withdrawal
  - One “E” Grade - Involuntary Withdrawal
- Maintain Continuous Enrollment

# Additional Support Services Available



- **Writing Support Services**
  - [writingsupport@warner.Rochester.edu](mailto:writingsupport@warner.Rochester.edu)
- **Quantitative Consulting Services**
  - [quantconsulting@warner.Rochester.edu](mailto:quantconsulting@warner.Rochester.edu)
- **Career Support Services**
  - Harriette Royer - [hroyer@warner.rochester.edu](mailto:hroyer@warner.rochester.edu)
- **University Health Services**
  - <https://www.rochester.edu/uhs/>

# Department of Public Safety

- For emergency services, call or text [\(585\) 275-3333](tel:(585)275-3333) or dial 911
- Pick up a Blue Light phone anywhere on a University campus to be put in touch with an officer immediately
- DPS services include: safety escorts, vehicle services, Medical Emergency Response Team (MERT), lost and found, crisis intervention
- Visit <https://www.rochester.edu/public-safety/> for more information



# Welcome to the Library!



UNIVERSITY *of* ROCHESTER



# Why meet the librarian?

- A “research coach” not a “shhh- er”
- Assisting you to find research articles, data, and tools for organizing your materials
- Helping you find research strategies that meet you where you are. We’re all on a learning journey.
- Citation management tools
- Connecting you to other support staff



# Library Resources

- Library homepage:  
<https://www.library.rochester.edu/>
- Research guide to Education and Counseling, including a place to make appointments with Eileen  
<https://libguides.lib.rochester.edu/edu>
  - Tab for [orientation materials](#)



# Research guide: <https://libguides.lib.rochester.edu/edu>

\* Education: Education & Counseling

Search this Guide

Search

Education & Counseling	Orientation and Tutorials for Warner Students	Open Educational Resources (OER)	Educational and Psychological Tests	Citing in APA	Zotero
Other Reference Managers	#BlackLivesMatter Booklist				

## Sign up to learn Reference Managers

Learn to use Reference Management Tools: Zoom class: Friday, September 10 from 12pm - 1pm [Register here](#)

Get the semester off to an organized start by learning about [reference managers](#). These are easy to use tools that can save you time by enabling you to create and manage your own digital library. You can use them to keep track of articles, books, websites, and other sources you need for your scholarship. With a few clicks you can organize your sources and generate citations or bibliographies in any style you want.

This virtual workshop will provide an introduction to three of the most popular reference managers, [Zotero](#), [Endnote](#), and [Refworks](#). Join us to how to get setup and learn how to most effectively use these tools.

We'll be offering drop-in office hours throughout the first half of the semester to help with any reference manager questions that emerge

## Finding Journal Articles using Databases

### Top databases for Education, Psychology and Linguistics

- DiscoverUR

The public search interface for all University of Rochester Libraries. It is a discovery layer rather than a single catalog, see [What is a discovery layer?](#) for more info.



#### Education Full Text

Identifies journal articles in education and related fields, many with links to the online full text.

[more...](#)

#### PsycINFO® APA PsycINFO via ProQuest

Identifies articles, books and dissertations in psychology and related subjects, many with links to full text, 1806 to current.

#### ProQuest® Linguistics and Language Behavior Abstracts - LLBA

Identifies articles, books and reports in linguistics and related fields, many with links to full text.



For off-campus access to full text: Click Scholar Preferences and add Rochester as your Library Link. Be sure to Save Preferences.

- ProQuest Education Journals

Identifies journal articles in education and related fields.

#### ProQuest® ProQuest Dissertations & Theses Global

Identifies Ph.D. dissertations from U.S. and Canadian universities since 1861. Abstracts from 1980. Many with full-text.

## Education Librarian



Eileen Daly-Boas

she/her/hers

Email Me

Meet with Me

Chat is unavailable right now, feel free to email me.

Contact:



UNIVERSITY of ROCHESTER

# Library Search

- Log in – when you start searching, be sure to login for best results, and easy ways to save searches

UR LIBRARIES

NEW SEARCH DATABASE SEARCH JOURNAL TITLE SEARCH SEARCH BY CITATION BROWSE SEARCH HELP

DISCOVERUR

counseling addiction

Articles, Books, & More

ADVANCED SEARCH

All items that contain my query words anywhere in the record

For complete results, log in with UR credentials [My Account](#) DISMISS

REFINE YOUR RESULTS

☐ Add results beyond your library's collection

Sort by Relevance

Availability

Available online

Peer-reviewed Journals

Open Access

Held by library

0 selected PAGE 1 121,383 Results Personalize

1

JMIR Research Protocols

ARTICLE

Implementation and evaluation of a text message-based addiction counseling program (text4hope-addiction support): Protocol for a questionnaire study

Agyapong, Vincent Israel Opoku ; Hrabok, Marianne ; Vuong, Wesley ; Gusnowski, April ; Shalaby, Reham ; Surood, Shireen ; Greenshaw, Andrew J ; Aulakh, Avininder ; Abba-Aji, Adam ; Singh, Mohit

JMIR research protocols, 2020-11-01, Vol.9 (11), p.e22047-e22047

“ With the emergence of the COVID-19 pandemic, providing counseling to people with drug or alcohol addiction while maintaining physical distance has been challenging...”

PEER REVIEWED OPEN ACCESS

Download Now Available Online

Browse Now



- **Refine** your results: peer reviewed journals, content type (articles) and by year.
- Click on the three dots (...) at the right of an article to get a citation, permalink, email the link to yourself, send to a citation manager.



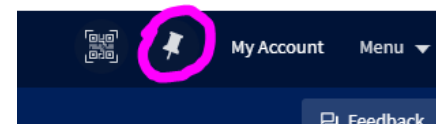

- If there's a search or an article that you'd like to "favorite" you can click the "pushpin" and they'll be available in your "favorites"





- Interlibrary Loan: for materials the library doesn't own/subscribe to:  
<https://illiad.lib.rochester.edu/>

2  ARTICLE  
**Language learners' enjoyment and emotion regulation in online collaborative learning**  
Zhang, Z ; Liu, T ; Lee, CB  
System, 98, 2021-06-01  
“ This study explores how language learners' enjoyment and emotion regulation manifest themselves in online collaborative learning... ”  
PEER REVIEWED OPEN ACCESS  
No Online Access >

 ARTICLE  
**Language learners' enjoyment and emotion regulation in online collaborative learning**  
Zhang, Zhipeng ; Liu, Ting ; Lee, Chwee Beng  
System (Linköping), 2021-06, Vol.98, p.102478  
“ This study explores how language learners' enjoyment and emotion regulation manifest themselves in online collaborative learning... ”  
TOP PEER REVIEWED  
MANAGE YOUR I... > Check holdings Rush Rhees Library Rhees Stacks (P51 .S95) >  
GET IT  
CITATIONS  
DETAILS  
Get It \_\_\_\_\_  
REQUEST: Request Other Issue / Interlibrary Loan - Miner/URMC /  
Interlibrary Loan - River Campus Libraries/RCL / Interlibrary Loan - Sibley/ESM /  
Digitize Article



# Google Scholar

<https://scholar.google.com/>

- When you're not sure what terms to use
- When you have an article that's a few years old, and you want to see who has cited that article since it's been published.

**Family**-based therapies for **adolescent alcohol** and drug use: Research contributions and future research needs

[HA Liddle](#) - *Addiction*, 2004 - Wiley Online Library

... cent relationship improved more in BFT than in support- ive group **counseling** ... that observational ratings of global **family** health (positive, developmentally adaptive **family** interactions) improved significantly from pretreatment to 12 months post- treatment among **families** in MDFT ...

☆   Cited by 281 Related articles All 21 versions 

[PDF] [wiley.com](#)  
Full Text @ UR



# Education Specific Resources

- Over 900 Education Journals
- Over 40 relevant databases
- Through the [Films On Demand](#) streaming-video database, students have access to over 1,500 videos or video segments on [education](#)



# Counseling-specific resources

- Approximately 100 counseling-related journals
- Approximately 700 psychology-related journals
- [\*Counseling and Psychotherapy Transcripts, Client Narrative and Reference Works\*](#): a collection containing real transcripts of therapy and counseling sessions and first-person narratives illuminating the experience.
- Through the [Films On Demand](#) streaming-video database, students have access to over 2,000 videos or video segments on [counseling](#) and [social work](#).
- [APA PsycTherapy](#) has over 300 videos featuring therapy demonstrations.



# Human Development resources

- Over 200 journals focused on child/human development
- Many databases, especially PsycInfo, PubMed, and SocIndex



- Keeping track of your sources:

<http://libguides.lib.rochester.edu/referencemanagers>

Reference (or citation) Management tools can help you keep track of your sources, and help you put your citations in your paper. You'll only need one:

- RefWorks - Lives in the cloud
- EndNote - Especially good if your research group/professors use it.
- Mendeley - works great if you have mostly pdfs in your research.
- Zotero - best one to use if you have a variety of kinds of sources: webpages, videos, images, pdfs and books. (<https://www.zotero.org/>)





# Best tips from Eileen

- If you're not getting good results – it might be your search terms
- Use quotation marks around words to search as a phrase “addiction counseling”
- The introduction/literature review section of a good research article can help you understand the “landscape” of research.
- If you're stuck, email Eileen or make an [appointment](#)!



# Upcoming Events

---

- Warner Resource Fair: 2/11/25 from 4 – 5:30
- Warner Research Days: April 4 & 5, 2025

## To do:

- Look for emails and the Warner Wire!
- Connect with your advisor!
- Consult your Program of Study (POS)
- Review the website
- Register!
- Look for Title IX training!



# Certification

- Pam Kaptein

Administrator for Assessment, Accreditation & Certification

<https://rochester.hosted.panopto.com/Panopto/Pages/Viewer.aspx?id=816722a4-9ce3-4b72-a2f7-b26001443b29>



# New Student Orientation Certification and Licensure

Pam Kaptein

Administrator for Assessment, Accreditation and  
Certification

Certification Officer

[certification@warner.rochester.edu](mailto:certification@warner.rochester.edu)

585-276-5405

Last updated Jan 2025



**WARNER**  
SCHOOL OF EDUCATION  
UNIVERSITY of ROCHESTER

# Certification Office Connections

- Record workshop completion
  - Students complete on their own timeline
  - Must be completed no later than one month before program completion
- Provide guidance on which provider to work with, for certification requirements
  - Fingerprinting
  - Workshops
  - Exams
- Support students through the process of applying for certification

[certification@warner.rochester.edu](mailto:certification@warner.rochester.edu)



# Students that can be dismissed

- Dismiss students registered in programs that don't lead to NYS certification or licensure:
  - Educational Policy
  - Higher Ed
  - Health Professions
  - Human Development (not ABA students)
  - Online Teaching and Learning
  - Program Evaluation
  - Doc programs without cert





# Programs remaining

- Applied Behavioral Analysis
  - Community Mental Health Counseling
    - School Counseling
      - Administrators
- Classroom Teaching



# Certification and Licensure

- On Warner home page (search “certification” or “licensure”):  
<https://www.warner.rochester.edu/students/support/certification>
- Orientation document
- Registration info for all workshops
- FAQ's re: Certification and Licensure
  - TEACH
  - Workshops
  - Certification Exams
  - Applying for Certification
  - Certificate Issuance
  - Miscellaneous
- Application for certification instructions
- NYS Program Codes for TEACH
- Form requesting recommendation in TEACH
- Confirmation letters
- Next steps to certification; when nearing program completion
- \*\*\***bookmark: Certification and Licensure Summary**



# Workshops

- Child Abuse Identification
  - Only workshop that is required for ABA and Mental Health programs
- Safe Schools Against Violence in Education (SAVE)
- DASA (Dignity for All Students Act)
- Recommend to complete each workshop as soon as possible. Advisor will let you know if there are program-specific requirements about timing.
- Only have to take each workshop once
- Registration information can be found on our website
- Reminders sent via email each semester
- Student sends certificate of completion to [certification@warner.rochester.edu](mailto:certification@warner.rochester.edu)
- Provider uploads certificate of completion to TEACH
  - The Office of Professions, for ABA and Mental Health licensure doesn't use the TEACH system, students need to retain the copy of the certificate of completion; will need for licensure



# Child Abuse Identification Workshop

- Two-hour training in the identification and reporting of suspected child abuse and maltreatment.
- Required for:
  - students seeking New York State certification in teaching, school counseling, and administration.
  - students seeking New York State licensure in clinical mental health counseling and applied behavior analysis.
- Complete workshop at [NYS Office of Children and Family Services](#)
  - Register for an account and complete through their system
- Submit certificate of completion
- First became a requirement in February 1991.
- Updated requirements recently; Anyone graduating after April 1, 2025 will need new content



# Fingerprint-Supported Background Check

- New York State requirement for:
  - certification applicants in teaching, counseling, and administration
  - anyone who is intending to work with children, either through ABA or CMHC licensure
- Complete your fingerprinting as soon as possible.
  - Many internships and student teaching placements cannot begin until fingerprinting has been complete.
- Fingerprinting done through IdentoGO: [www.identogo.com](http://www.identogo.com) .
  - Set up account
  - Answer questions related to citizenship, and other essential info.
  - All information is online at NYSED/OSPRA (Office of School Personnel Review and Accountability).
    - <http://www.nysed.gov/educator-integrity/fingerprint-process>
  - NYSED Fingerprint Helpdesk; [ospira@nysed.gov](mailto:ospira@nysed.gov) or call (518) 473-2998.



Be kind to your  
future self!





# Dismiss Programs

Candidates in the following programs can be dismissed:

- CMHC
- ABA



# SAVE Workshop

SAVE (Safe Schools Against Violence in Education) workshop:

- Two hours of training in school violence prevention and intervention
- Required for students seeking New York State certification in teaching, school counseling, and administration.
- Opportunity to complete workshop through Genesee Valley BOCES
  - One-time registration fee covered for students matriculated in a program that leads to NYS certification or licensure.
    - Register for an account and complete through their system
    - Deadlines determined by your registration date
    - If you miss the deadline for course completion for any reason, you will be responsible for any subsequent registration costs
- Can choose to complete at any [NYS-approved provider](#)
- Submit certificate of completion
- Became a requirement in February 2001



# DASA (Dignity For All Students Act) Workshop

- Six hours of training in Harassment, Bullying, Cyberbullying, and Discrimination in Schools: Prevention and Intervention
- Required for students seeking New York State certification in teaching, school counseling, and administration.
  - Opportunity to complete workshop through Genesee Valley BOCES
    - One-time registration fee covered for students matriculated in a program that leads to NYS certification or licensure.
      - Register for an account and complete through their system
      - Deadlines determined by your registration date
      - If you miss the deadline for course completion for any reason, you will be responsible for any subsequent registration costs
    - Two-part training:
      - Three-hour part I component
      - Confirmation of completion of all modules
      - Three-hour part II
  - Can complete at any [NYS-approved provider](#)
  - Submit certificate of completion
- Became a requirement in January 2014;
  - likely will need it if seeking a second certification



# Exams

- NYSTCE testing requirements will depend on the subject area(s) of certification.
  - [www.nystce.nesinc.com](http://www.nystce.nesinc.com)
- Content Specialty Test (CST)
  - Each subject area
- Educating All Students (EAS)
- Requirements specific to area of certification  
<http://eservices.nysed.gov/teach/certhelp/CertRequirementHelp.do>
- Be sure to select University of Rochester to receive results (not school district)



# TEACH records

- Keep name current in the TEACH system
- If you're a Jr. or III or have a name change, needs to be exactly how listed on your legal identification
- <http://www.highered.nysed.gov/tcert/namechg.html>



# Certification student to-do list

Things you can do now:

1. Register for TEACH account
  - Same NYS system as DMV and unemployment
2. Review requirements specific to area of certification:

<http://eservices.nysed.gov/teach/certhelp/CertRequirementHelp.do>

3. Complete fingerprinting process
4. Complete all workshops





# Have a Great Semester!



## Mission statement

At the Warner Graduate School of Education and Human Development, we believe that education can **transform lives and make the world more just and humane.**



**WARNER**  
SCHOOL OF EDUCATION  
UNIVERSITY of ROCHESTER

Thanks for Joining Us!

Any questions?

